

## HOW TO MEASURE FOR PORCH ENCLOSURE PANELS   Rough Opening

Notice - SummerSpace will build the panels using 1/4" standard deduction (1/8" per side) to ensure they will fit the opening unless otherwise specified. Shimming work will be necessary for proper fitment.

- Overall dimensions for each opening are required for order processing.
- SummerSpace Porch Enclosure Panels are custom fabricated for each opening and must be measured accurately. Be careful to allow for any irregularity which will interfere with the proper fitment of the unit (examples include but are not limited to: handles, irregular or decorative trim, or opening not square and plumb).
- Measure from six positions at each opening—top, center, and bottom for the width; left, center, and right for the height.
- Width: Provide SummerSpace with the overall square/plumb opening width. NOTE we will make a standard 1/4" deduction to ensure proper fitment inside the opening.
- Height: Provide SummerSpace with the overall square/plumb opening height. NOTE we will make a standard 1/4" deduction to ensure proper fitment inside the opening.
- If the panel dimensions exceed the maximum allowable width, SummerSpace will provide multiple panels to satisfy the opening.
  - Panels will be split evenly to provide symmetry within the opening unless otherwise specified.
- The manufacturer bears no responsibility for mismeasurements.



## Label each opening.

- Openings should be labeled by letter in a manner that is logical and will make sense to the installer.
- Each panel and its components will be marked with this label for reference during installation.

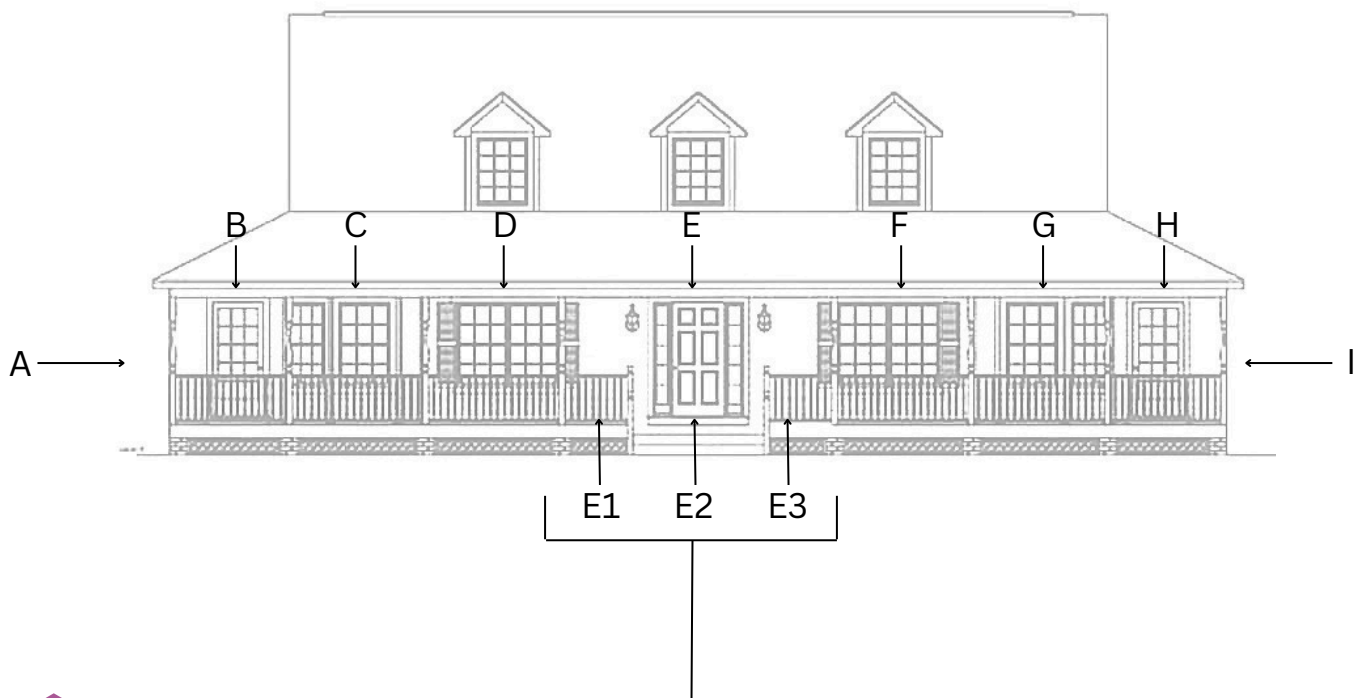

## Label each panel.

- If multiple panels will occupy the same opening, they will be labeled by number.
- Each panel and its components will be marked with this label for reference during installation.



- SummerSpace Porch Enclosure Panels are custom fabricated for each opening and must be measured accurately. Be careful to allow for any irregularity which will interfere with the proper fitment of the unit (e.g.- opening not square and plumb).
- Measure from six positions at each opening—top, center, and bottom for the width; left, center, and right for the height.

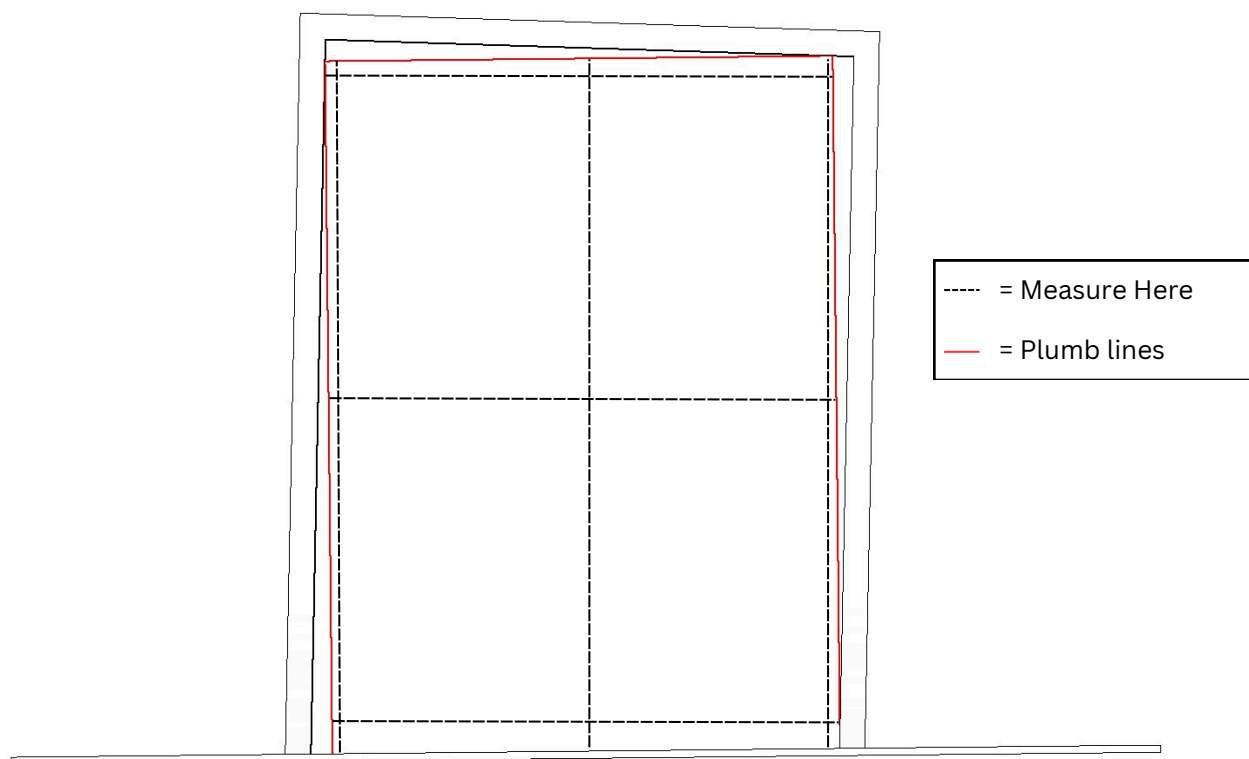

- Use a level to make markings representing a plumb opening. (Red lines above)
- Measure from your marks to find your plumb opening dimensions.
- Submit the plumb opening dimensions.
- Shims or furring work will be required for proper fitment.

## Proper Panel Fitment

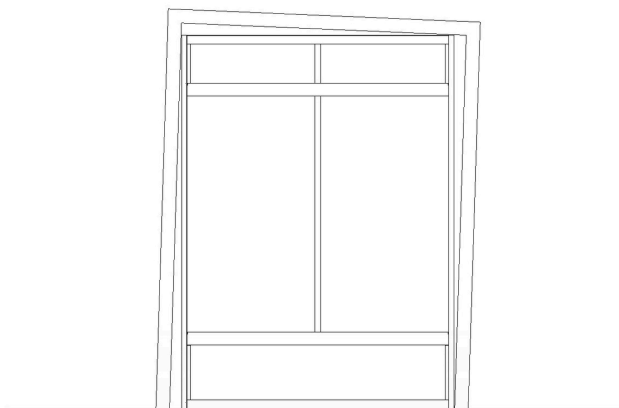



- If the panel dimensions exceed the maximum allowable width, SummerSpace will provide multiple panels to satisfy the opening.
  - Panels will be split evenly to provide symmetry within the opening unless otherwise specified.
- When ordering your panel(s), specify the exact width and height of the **opening**. SummerSpace will make a standard deduction to ensure the panel(s) fit inside the specified opening.

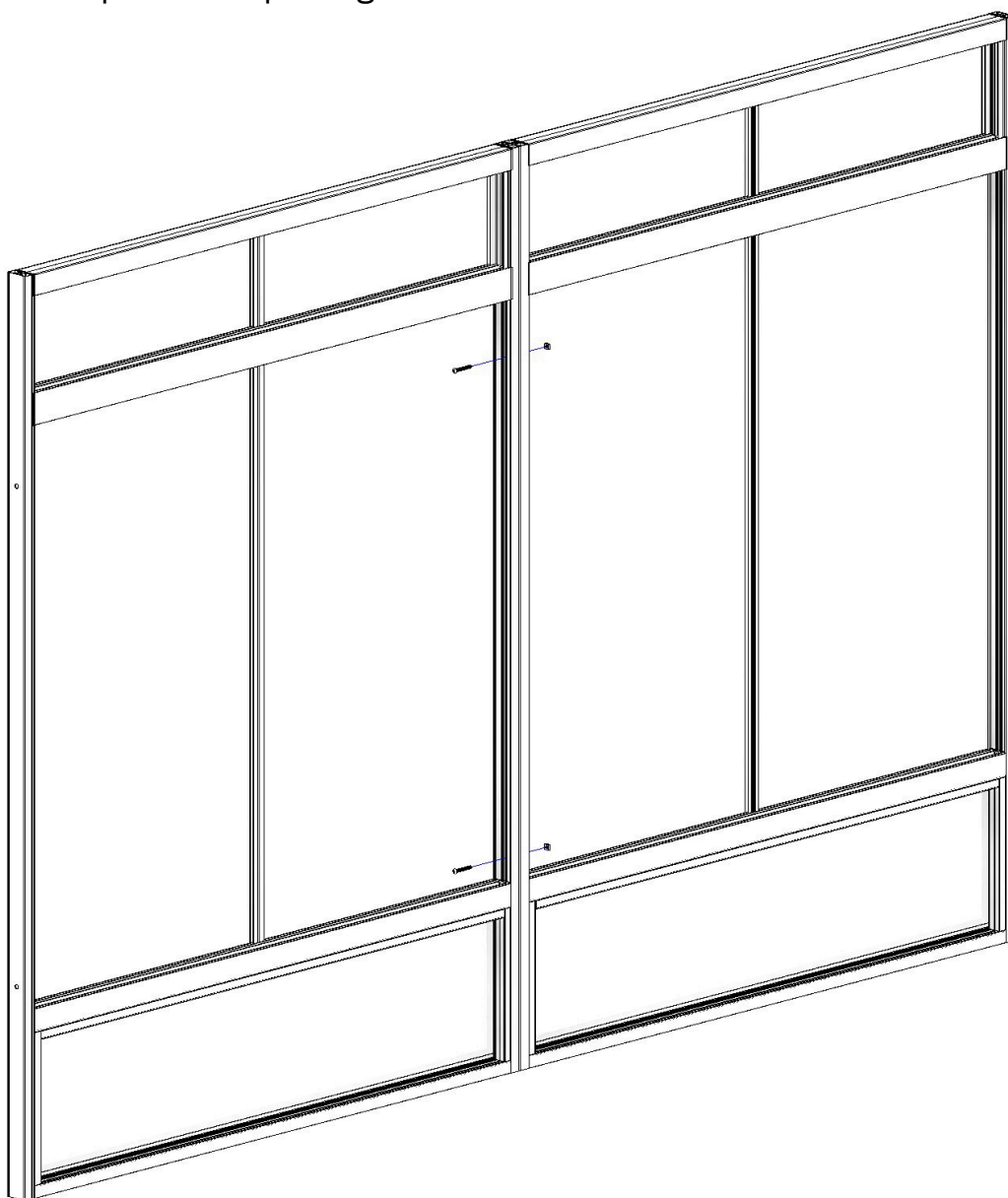



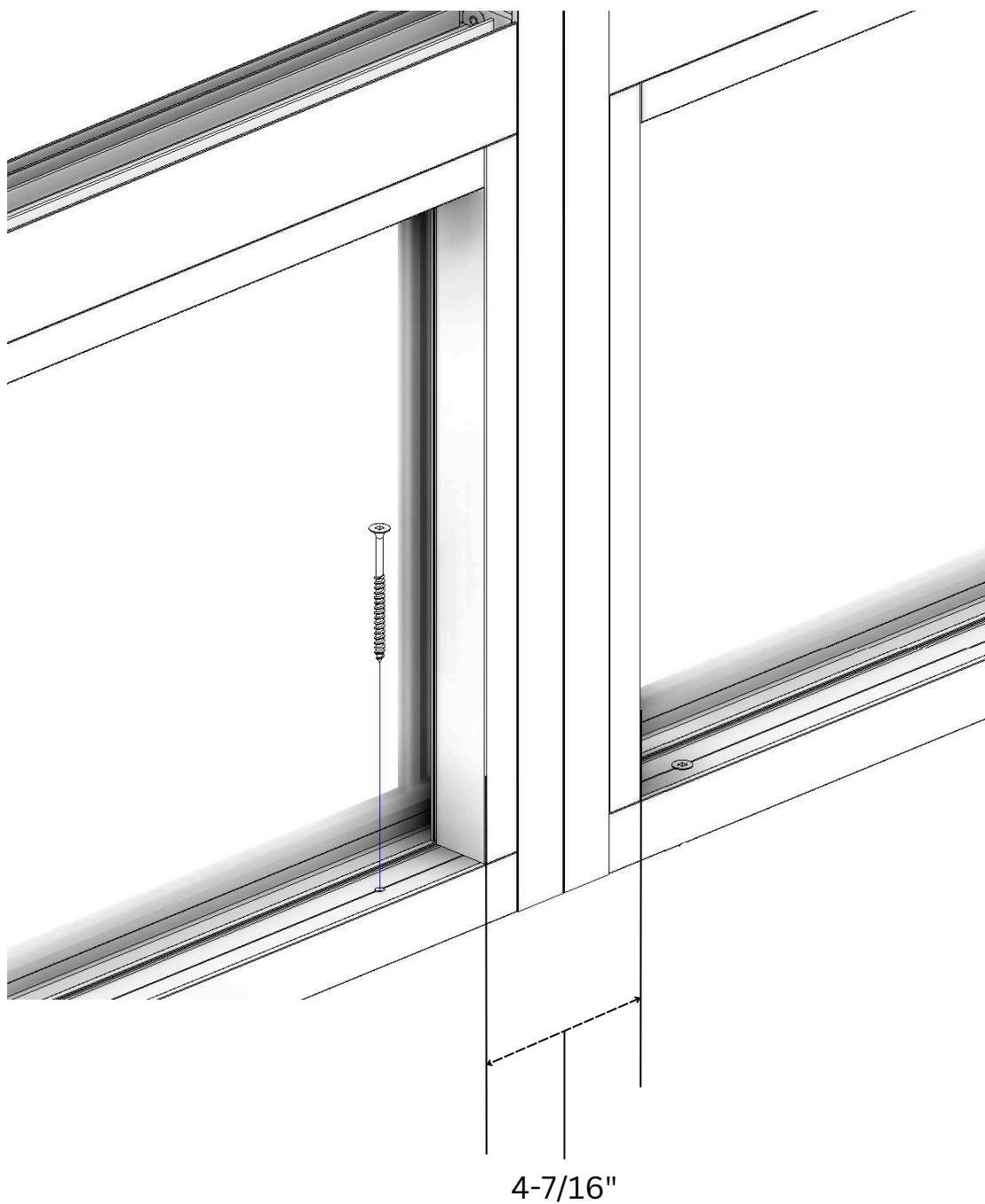

Overall width of the center post for muller panels is 4-7/16"



Vertical rail width, including the window insert is 2-1/4".

The overall panel frame depth from the inside of the panel to the outside is 2-1/2"

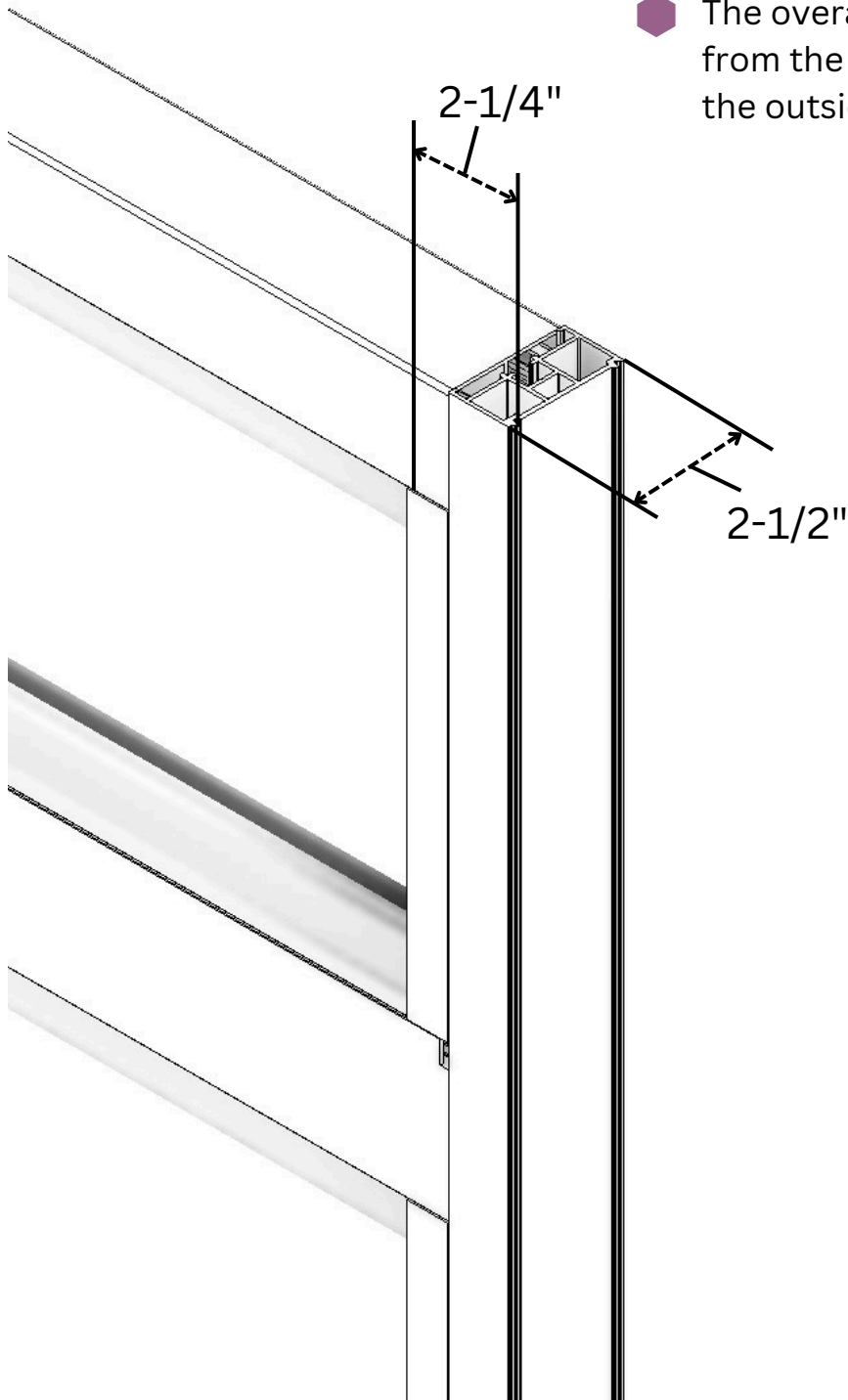



# 04 PANEL DIMENSIONS

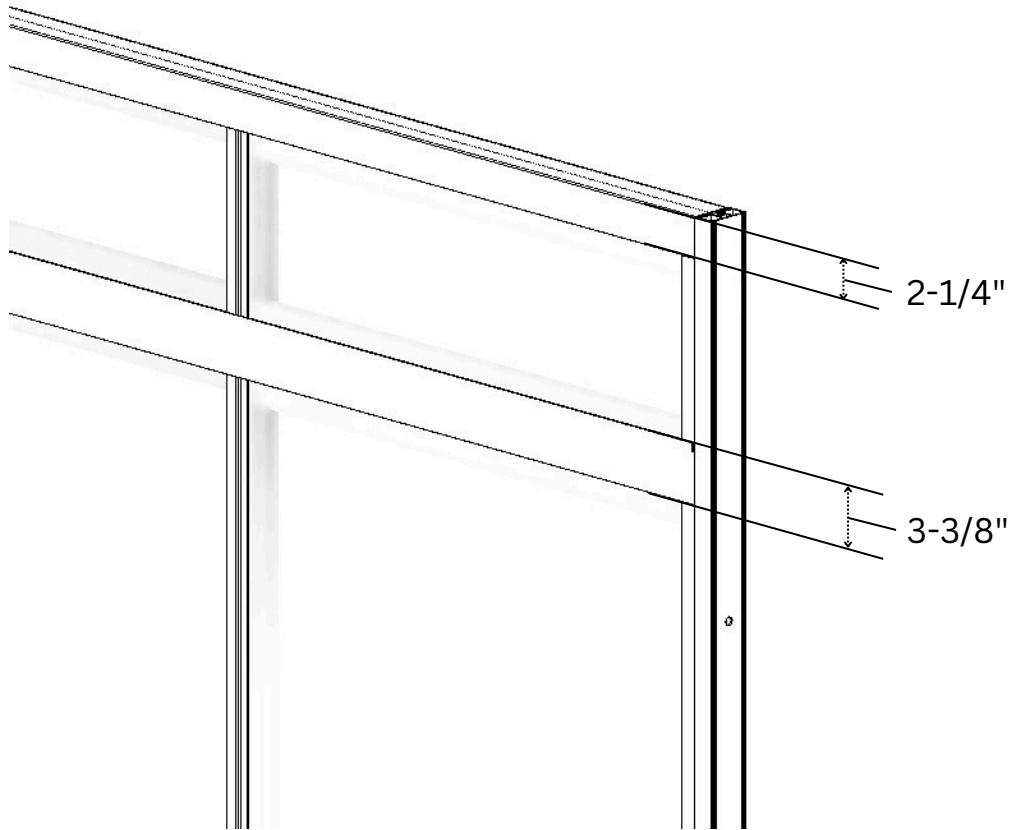

■ The upper horizontal fastener rail is 2-1/4".

■ The transom/main window section divider is 3-3/8"

■ The Base/main window section divider is 3-3/8"

■ The lower horizontal fastener rail is 2-1/4".

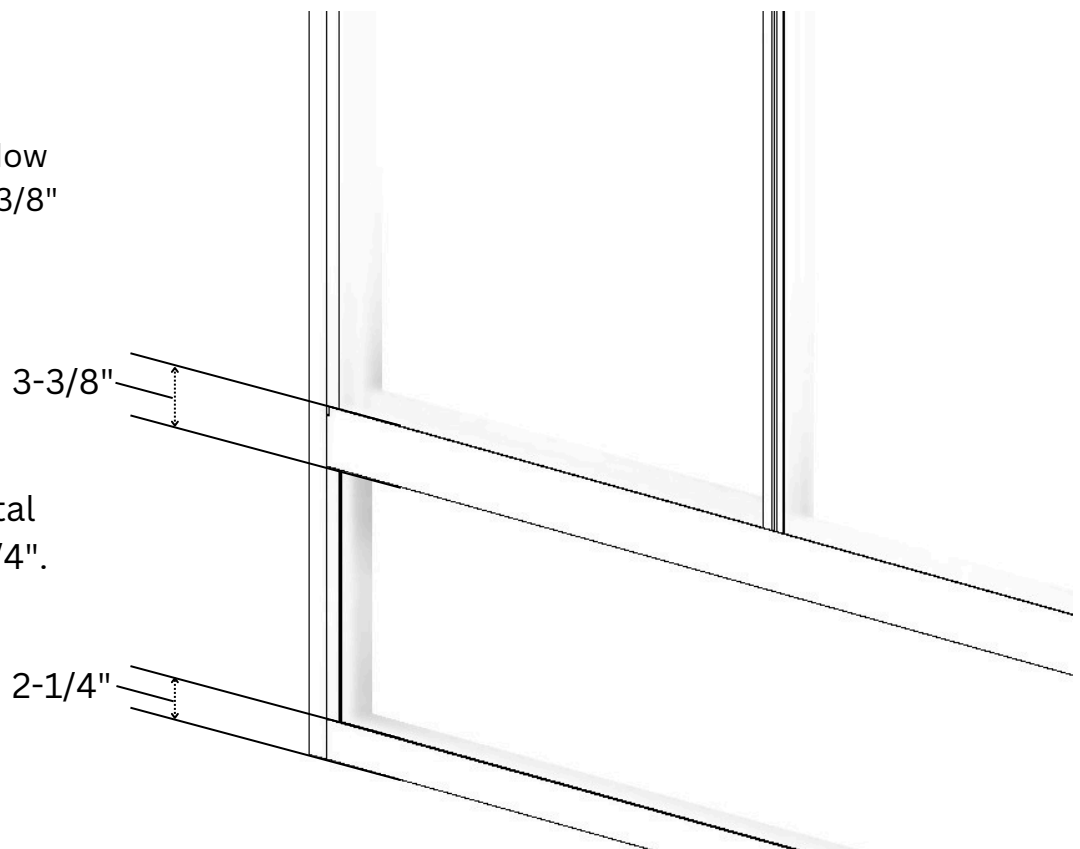



- Base section measurement is defined from the bottom of the panel to the **CENTER** of the horizontal section divider.
- Deduct  $1\frac{11}{16}"$  from the desired top of the horizontal section divider to determine the kickplate order height.

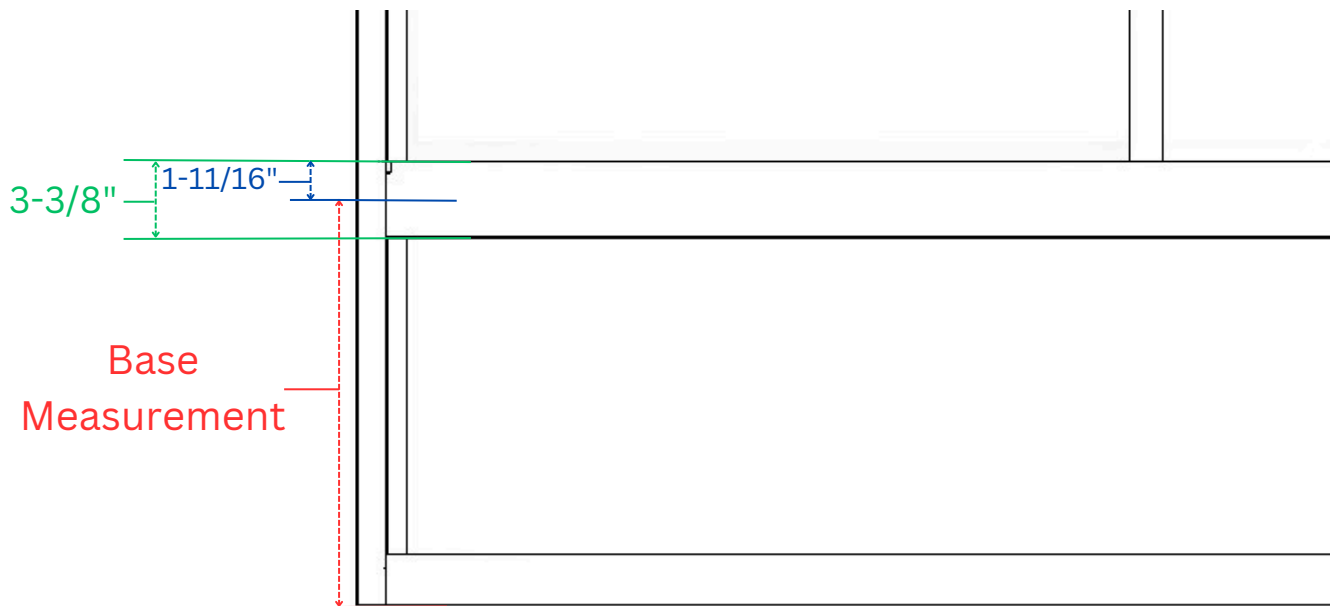

- Transom Window section measurement is from the top of the panel to the **CENTER** of the horizontal section divider.
- Deduct  $1\frac{11}{16}"$  from the desired bottom of the horizontal section divider to determine the Transom order height.

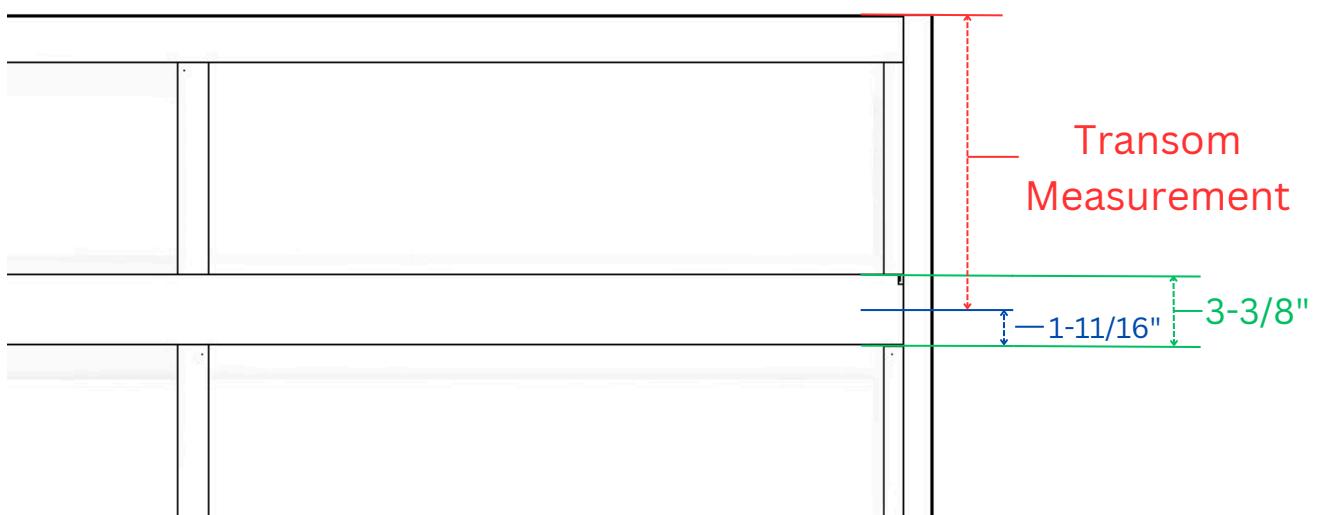



- ◆ The Storm Door Frame Panel is designed to fit any standard Z-bar style storm door. (**SummerSpace does not supply the storm door**)

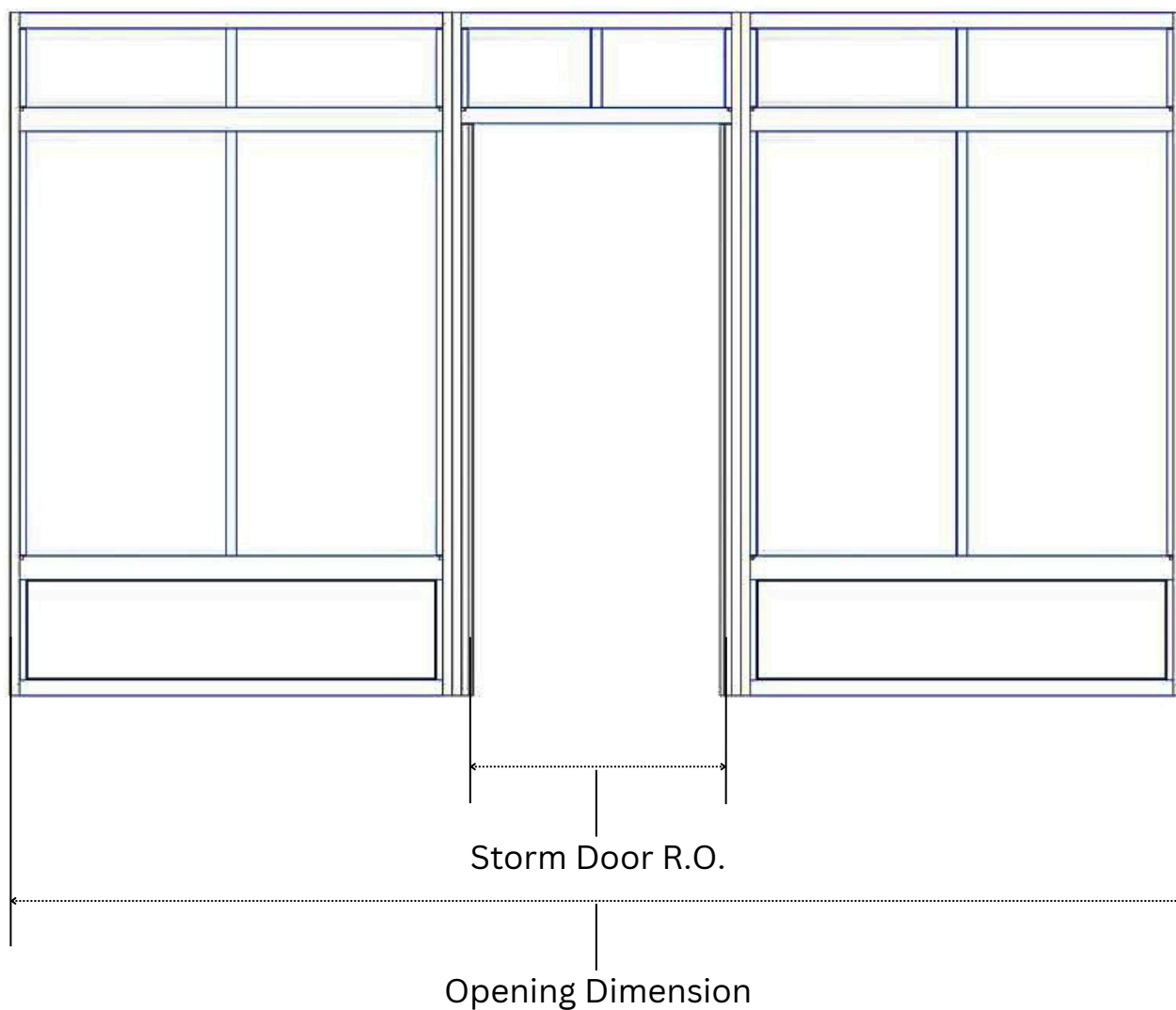

- ◆ Please provide both the overall opening dimensions and the R.O. requirements for the desired storm door.



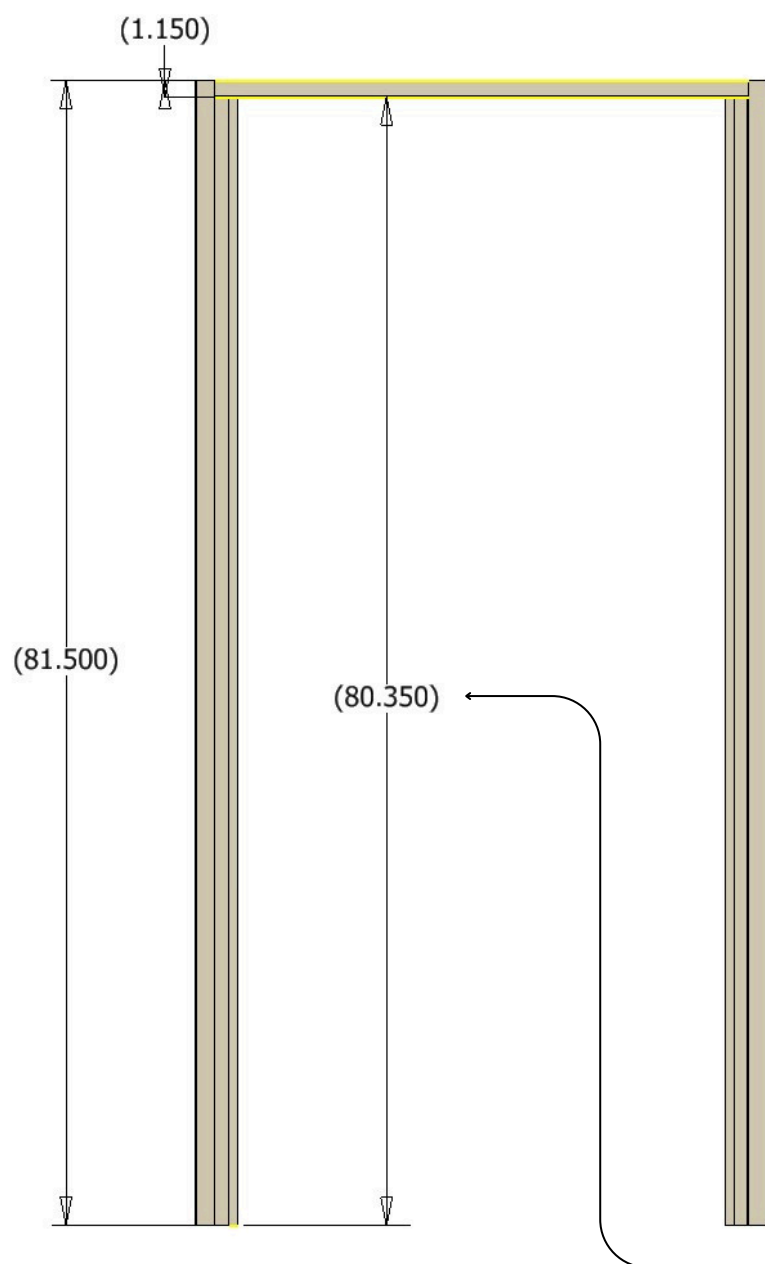

Example panel for an **80"H** R.O. Storm Door.

Storm Door Frame Panels **without** a transom; add 1-1/2" to the R.O. height of the Storm Door that you intend to use to calculate the overall height of the panel.

.350" of clearance is given to the inside of the storm door panel opening.

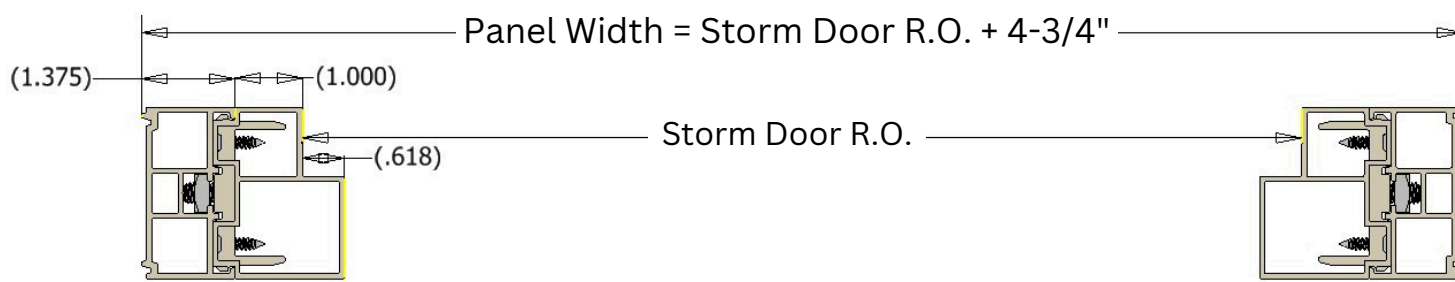



- Exclusively on the Storm Door Frame, the Transom section dimension is measured from the top of the panel to the **BOTTOM** of the horizontal divider.

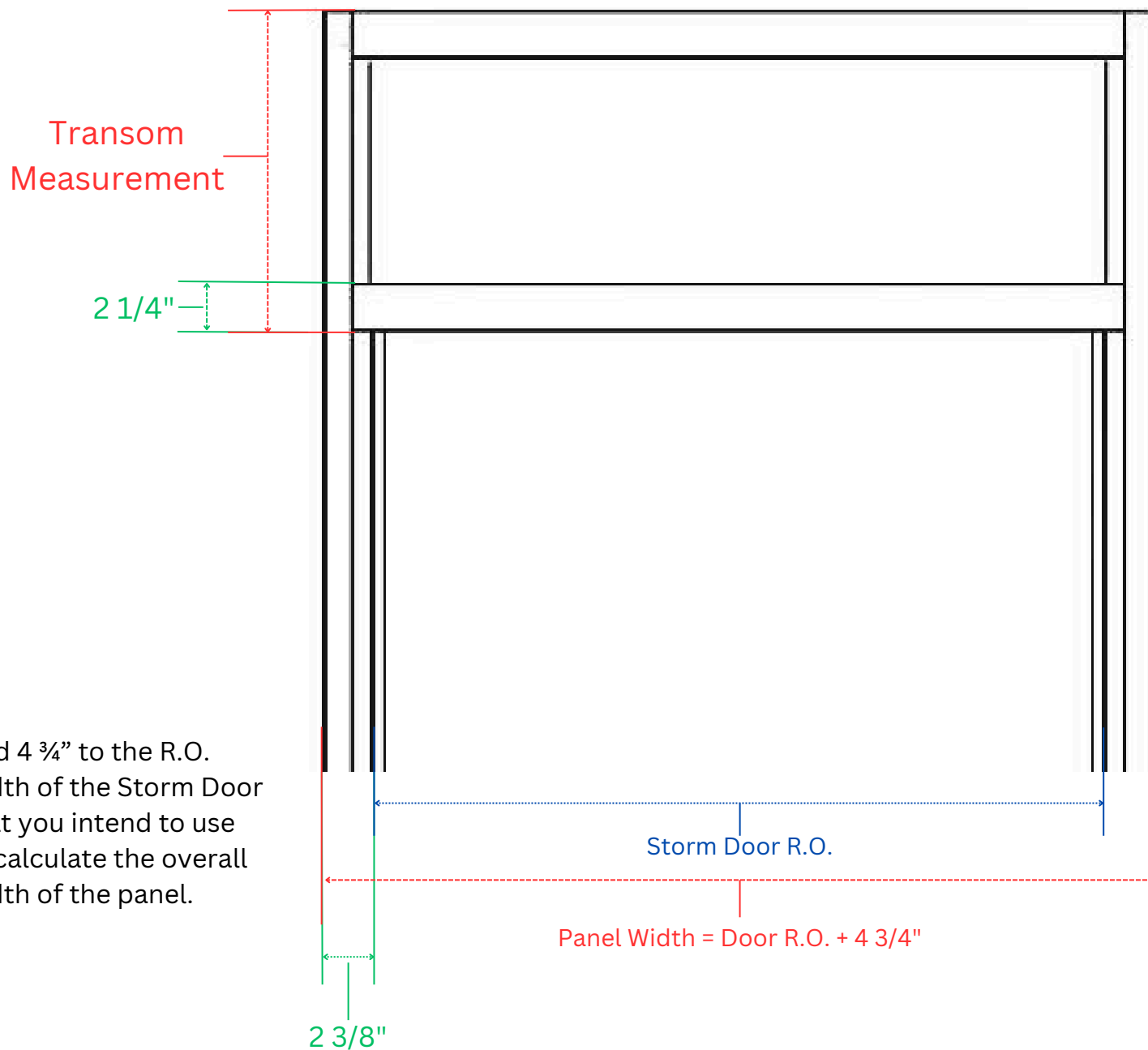

- Add  $4 \frac{3}{4}"$  to the R.O. width of the Storm Door that you intend to use to calculate the overall width of the panel.



- ◆ The difference between transom section above a Storm Door Frame Panel and a Window Panel transom is  $9/16"$

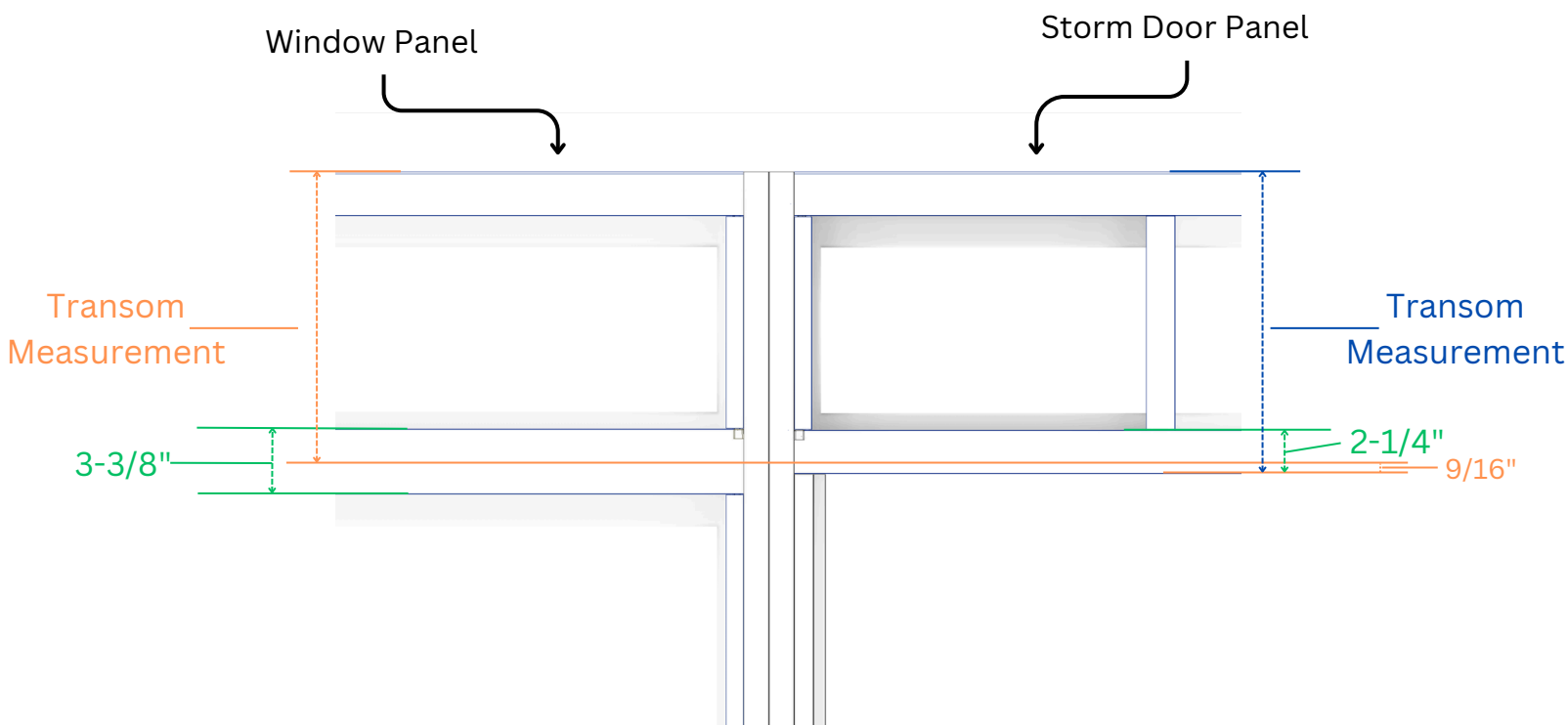

- ◆ The Transom section measurement of a Window Panel is from the top of the panel to the **CENTER** of the horizontal section divider.

- The Transom section of a Storm Door Frame Panel is measured from the top of the panel to the **BOTTOM** of the horizontal section divider.